



ETHOS[®] EDGE

GETTING STARTED PACK



diagnostics.snapon.com/ethosedge



FEATURES

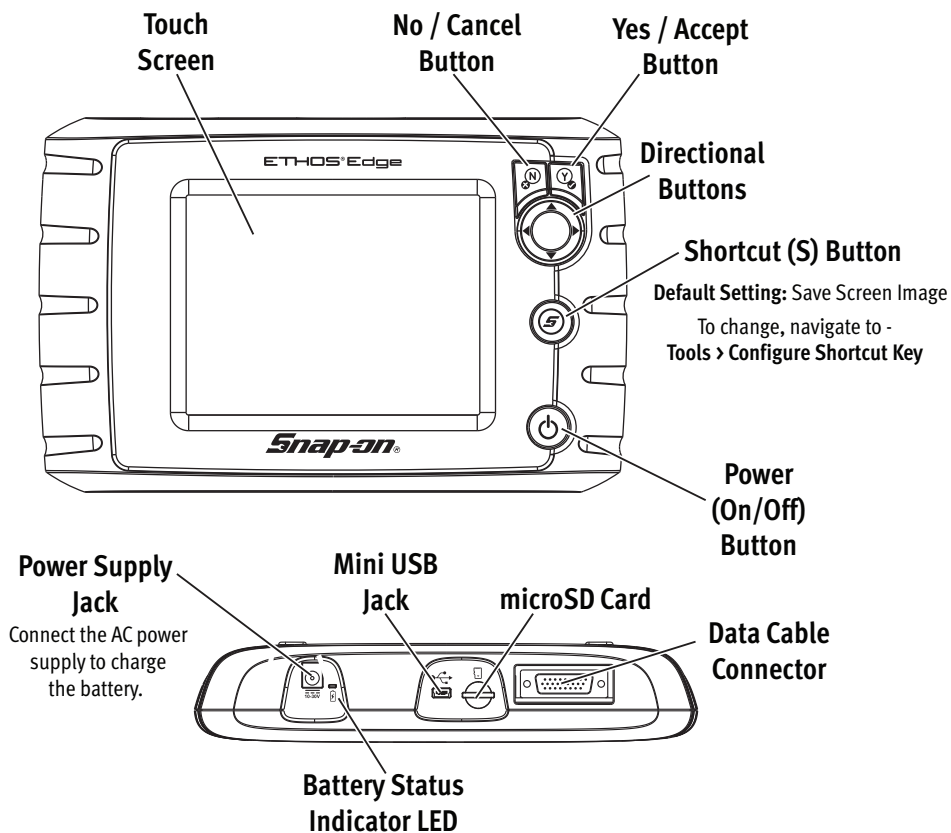

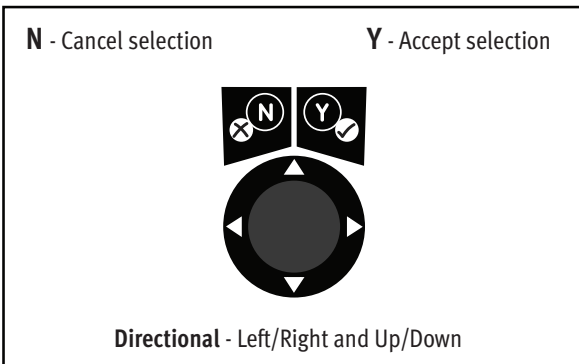
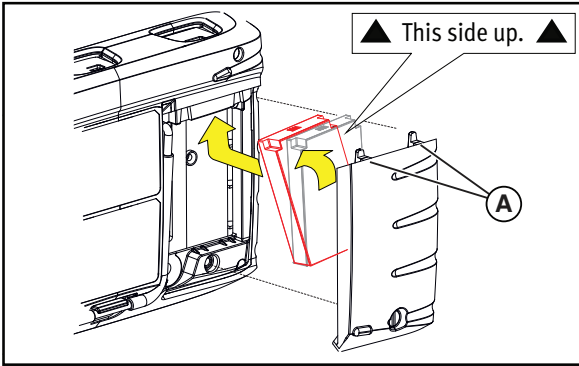

GETTING STARTED



1. Loosen the battery cover screw and remove the battery cover.
2. Position the battery pack (as shown) with the arrows facing up. Tilt the top of the battery in to align the tabs, then down to install.
3. Install the battery pack cover, (in the same manner as above) aligning the tabs (A) and screw.
4. Tighten the screw.
Note - Do not overtighten the screw.

5. Press the Power  button.

 *****IMPORTANT***** 
Turn Wi-Fi on to use Quick Lookups.

6. To turn on Wi-Fi:
 - a. From the Home screen, select **Tools > Settings > Configure Wi-Fi**.
 - b. Select the Wi-Fi  icon.
The icon will change to  indicating Wi-Fi is on.
 - c. Select a wireless network from the list of available networks, then select **Connect**.
7. Select a function (e.g. **Scanner**, or **Quick Lookups**).
8. Navigate menus and functions using the touch screen, or the control buttons.



User Manual

Download the user manual from:
diagnostics.snapon.com/usermanuals



Scanner

Retrieve and clear diagnostic trouble codes (DTCs), view parameter (PID) data, perform functional component tests, and adaptive relearns.

Scanning (Basics) / Demonstration Mode

1. Select **Scanner** from the Home screen.
2. Identify the vehicle, or to become familiar with the Scanner without connecting to a vehicle, select **Demonstration** from the menu to navigate through a simulated vehicle identification process, and explore the capabilities of the tool.
3. Follow the onscreen instructions to connect the data cable to the vehicle.
Note: If using “Demo Mode” do not connect the data cable to the vehicle.
4. Select a system (e.g. **Engine, Transmission, Body, etc.**).
5. Select a function or test (e.g. **Codes Menu, Data Display, Functional Tests, etc.**).

Control Icons

Pause Record



Pause and Display the data being aquired.

Back Forward



Navigate through data in singular and multiple steps.

Clear



Erase current data and begin new recording.

Sort



Change the listed parameter order.

Trigger



Set, arm, and clear PID threshold values.

Zoom



Increase/decrease magnification of the data.

Custom Data List



Select which parameters to display.

Change View



Toggle between list and graph view.

Lock / Unlock



Lock/unlock the highlighted parameter.

Tools



Open the tools menu.

Save



Save the data being aquired.

Code Scan

Code Scan collectively displays trouble codes read from vehicle control modules. The results can be saved to a file and reviewed on the tool, or transferred to a PC with ShopStream Connect™. From ShopStream Connect the results can be printed for your customers.



Quick Lookups



Quick Lookups makes finding valuable OEM service information and functional scanner tests easy!

Menu Options:

- **Oil Specs and Resets:**

Lookup engine oil specifications and reset the service interval.

- Capacity Information and Specifications
- Scanner Reset of Service Interval
- OEM Reset Procedures and Information

- **Tire and Wheel Service:**

Perform TPMS functional tests and indicator resets. View reset/repair procedures and tire fitment specifications.

- Reset Procedures and Information
- Repair Procedures
- Scanner Reset of Service Indicator
- Tire Fitment Specifications



OBD-II/EOBD

Quickly access global OBD-II/EOBD codes, tests, and data without having to identify the vehicle.

Menu Options:

- **OBD Direct** - access OBD-II/EOBD service modes (e.g. \$01 to \$0A), allowing you to view current diagnostic trouble codes, parameter data, freeze frame information, O2 sensor monitoring test results, check calibration numbers, and more!
- **OBD-II Health Check** - quickly check or clear diagnostic trouble codes, check readiness monitor status, and MIL status.



Previous Vehicles and Data

Save setup time when re-testing a vehicle, and review your saved files.

Menu Options:

- **Vehicle History** - lists the last twenty-five vehicles selected.
- **View Saved Data** - lists saved data files (last 50), including screen images.
- **Delete Saved Data** - permanently erases saved files from memory.

Print Data Files and Code Scan Reports, Download Software Updates, and more using ...

ShopStream
CONNECT™

ShopStream Connect (SSC) is a companion PC application available at no cost that gives you the ability to connect your diagnostic tool to your PC.

1. Get started by downloading and installing the SSC application onto your PC.

Download SSC at: diagnostics.snapon.com/ssc

Download the SSC user manual at: diagnostics.snapon.com/usermanuals

2. Connect the USB cable to the diagnostic tool, and your PC.

3. From the diagnostic tool, select **Tools > Connect-to-PC**.

4. Use the SSC application to to:

- **Print** data files, and Code Scan reports
- **Download Software Updates and Upgrades**
- **Transfer** data files bi-directionally between the tool and your PC
- **Save and Manage** data files
- **Add Notes** to your data files

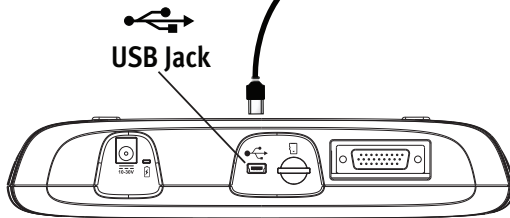
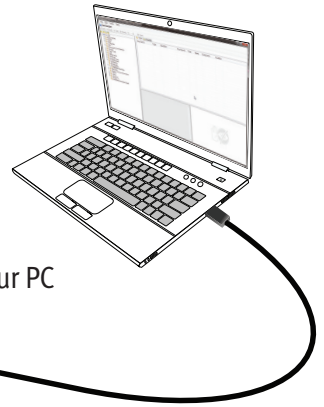

Kit Contents

(and Accessories/Extras)

The following are included with your ETHOS Edge kit:

- ETHOS Edge Diagnostic Tool and Battery Pack
- AC Power Supply
- OBD-II Data Cable (DA-4)
- Getting Started Pack
- Mini USB Cable
- Soft Carrying Case

Contact your Snap-on representative about accessories and extras, including these and more!

- OBD-I and European Data Cable Adapters
- Screen Protectors

Customer Support

Phone: (800) 424-7226

Email: diagnostics_support@snapon.com

Website: diagnostics.snapon.com

Safety Information

Before using this diagnostic tool, read and understand the *Important Safety Information* document provided within this kit. The *Important Safety Information* document is also available at: diagnostics.snapon.com/usermanuals



User Manual

Download the ETHOS Edge user manual from: diagnostics.snapon.com/usermanuals

Warranty Activation and Extension

To activate your warranty, and ensure you have access to the latest software upgrades, register your diagnostic tool today.

U.S. Customers: store.snapon.com/ProductRegistration.aspx

Canadian Customers: snapon.com/productregistration

Extended warranty protection is available for an additional 12, 24 or 36 months.
Contact your local Snap-on representative for information.

Software Subscription Program

Snap-on is continually enhancing our diagnostic software to provide our customers with the latest information available, not only for new vehicles but for older vehicles as well.

As revisions become available, we offer them in each new software release.

The Snap-on Software Subscription Program is the no-hassle, low-cost way to automatically get the latest codes, data, tests and exclusive coverage for thousands of new vehicle systems.

To find out more, visit: diagnostics.snapon.com/theprogram

Important Information

Before using this diagnostic tool, read and understand:

- The *Important Safety Information* - included in this kit
- The *ETHOS Edge User Manual* - available online at:
diagnostics.snapon.com/usermanuals

Get the most from your new diagnostic tool.

The latest software upgrades are as close as your Snap-on Representative's van, or for more information visit: diagnostics.snapon.com/ethosedge

Training Solutions[®]

To maximize your productivity, Snap-on Training Solutions offers in-depth, multi-level training at no charge, available 24/7 at: diagnostics.snapon.com/trainingsolutions

Snap-on is a trademark, registered in the United States and other countries, of Snap-on Incorporated. All other marks are trademarks or registered trademarks of their respective holders. ©2018 Snap-on Incorporated. All pictures and illustrations shown are for reference purposes only. All information including specifications herein are subject to change without notice. EAZ0102L40B Rev. A

ETHOS[®] EDGE

GETTING STARTED PACK

The Snap-on logo is located in the bottom right corner of the page. It features the word "Snap-on" in a stylized, italicized font with a metallic, 3D effect. The letters are white with black outlines and shadows, giving it a sense of depth and industrial strength. The logo is set against a dark red background.